

BXP01 Series Hazardous Area Power Supply Box

Spec Sheet

Overview

The Tormin BXP01 is an incredibly flexible product ideal for use in almost any hazardous area.

Features & Benefits

- The junction box is compact, lightweight and easy to install.
- Anti-corrosive coating.
- ATEX Certified zone 1, zone 21, zone 2 & zone 22, Certified by Eurofins product testing, Italy.
- 5 year warranty.



Technical Specification

Description: BXP01 Series Hazardous Area Power Supply Box

Recommended Product Location: Hazardous areas

PRODUCT DETAILS	
Ex mark	Ex d IIC T6 Gb, Ex tb IIIC T80°C Db IP66,
Voltage	90-264VAC 50/60Hz
IP Rating	IP66
Typical Lumens per watt	N/A
Colour Rendering	N/A
LED Module	N/A
Beam angle	N/A
Operating Temperature	-25°C/+55°C
Colour Temperature	N/A
Power Factor	N/A
Driver	N/A
Dimension	238*222*106mm
Warranty	5 Year Repair / Replace Warranty
Number of Cable Inlets	1-3
Screw Thread of Cable Inlets	G3/4" M20*1.5, M25*1.5, NPT1/2", NPT3/4"
Net Weight	2.9 KGS

PRODUCT OPTIONS	
Occupancy Sensor	N/A
Light level sensor	N/A
Remote Programmable Sensor	N/A
High borosilicate glass front	N/A
RGB	N/A
18-43VAC/18-55VDC	N/A
Emergency	10w, 20w , 30w
Fixed Bracket Mounting	✓

Ambient Temperature / Temperature Group

Circuit Watts	TA ≤55°C
N/A	T6

Performance Chart

RATED WATTS	EMERGENCY DURATION
10 w	180 min
20 w	90 min
30 w	60 min

Diagram of BXP01 series

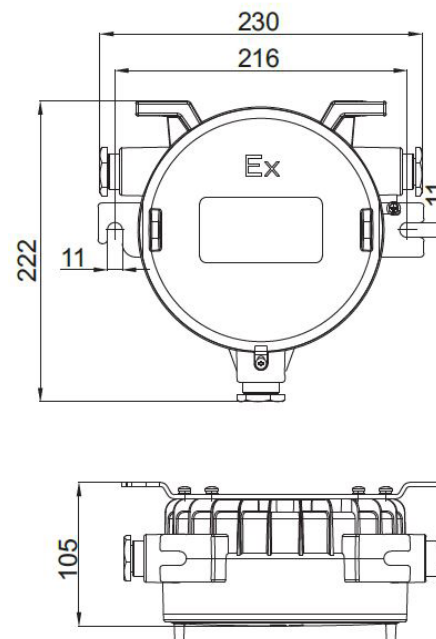

The Tormin BXP01 series is covered by our 5 Year repair/replace Warranty. Warranty upgrade packages available. UK purchases, warranty handled through Carbon8Lighting.

www.carbon8lighting.co.uk
01256 300031
sales@c8l.co.uk

CARBON8
LIGHTING

